

## Module Selection Guide

### Connector module

NM3FXI  
XLR female  
M17x1 outside

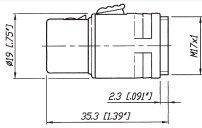

NM3MXI  
XLR male  
M17x1 outside

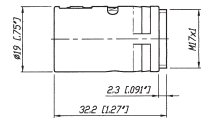

NM2P  
mono 1/4" plug  
M17x1 inside

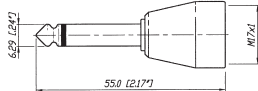

NM3P  
stereo 1/4" plug  
M17x1 inside

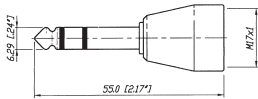

NM3J  
stereo 1/4" jack  
M17x1 inside

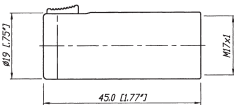

NMPMM  
RCA male  
M17x1 inside

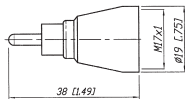

NMPMF  
RCA female  
M17x1 inside

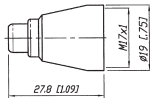

NM3FD-B  
black plated  
D-Shape

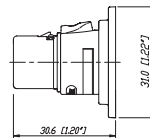

NM3MD-B  
black plated  
D-Shape

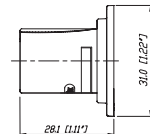

### Coupler / housing

KM  
M 17x1 inside



KMX  
M 17x1 inside

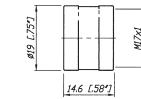

VM  
M 17x1 outside

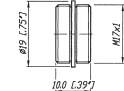

VMX  
M 17x1 outside

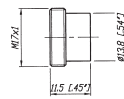

CM  
cable outlet  
M 17x1 inside

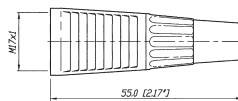

NA-Housing<sup>1)</sup>  
black plated  
screws included

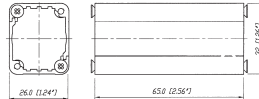

### Transformer / switch

NTE1  
1:1

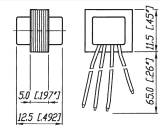

NTE4  
1:4

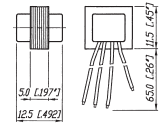

NTE10/3  
1:3:10

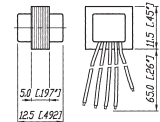

SM2/2  
2x2 switch  
M17x1 outside

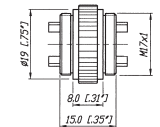

1) ... Combinations possible with all D Shape connectors like e.g. NC3FD-L-1, NF2D, NBB75DSI, etc.

### Example:

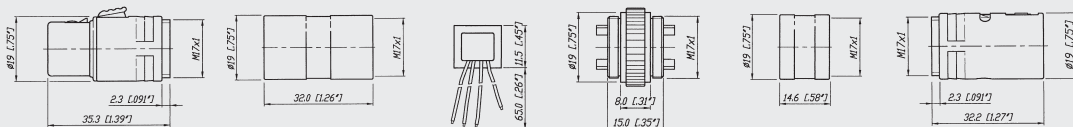

NM3FXI

KM

NTE1

SM2/2

KMX

NM3MXI

